

# Moisture Ejector

## Replacement Parts

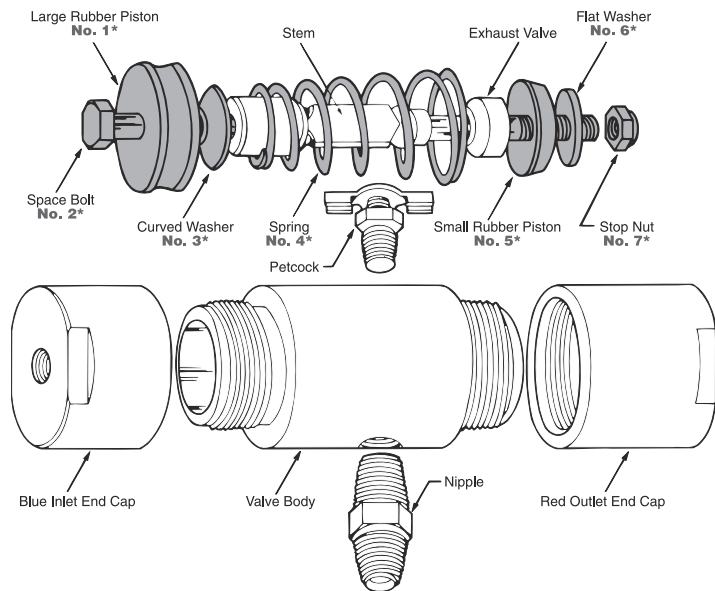

**\*NOTE: Only the numbered parts (1-7) shown at left are in Repair Kit No. 900-1080.**

**The complete assembly is shown to assist in proper re-assembly.**

## Moisture Ejector Assembly Instructions

- Use bench vice and chain or crescent wrenches to disassemble and assemble moisture ejector.
- Remove caps from both ends and disassemble the interior components, taking care to note the location of each part.
- Prior to assembly, carefully wipe away dirt or foreign matter from inside of both caps and the barrel and seats of the body. Lightly grease the barrel and seats with the moly grease provided in the rebuild kit.
- Place large rubber piston **no. 1** on the spacer bolt **no. 2** with vendor name toward the hex head. Next, assemble curved washer **no. 3**; stem; and spring **no. 4** with the small end seated on the curved washer, on the spacer bolt. Fill outer edge of the large rubber piston with grease prior to inserting assembly into the barrel of body
- Place exhaust valve so that it slips over the collar of the stem, and small rubber piston **no. 5** with the concave side toward the exhaust valve. Then place flat washer **no. 6**, with the slightly rounded outer edge next to the top of the piston, fill the exposed threads on the spacer bolt with grease and install stop nut **no. 7**. Torque the stop nut to 45-50 inch pounds.
- Lightly grease the threads on each end of body, outer edge of the small rubber piston, and inside surface of the outlet cap. Install inlet and outlet caps, making sure the blue inlet cap is placed on the end with the large piston, and tighten.

## Preventive Maintenance

To assure proper operation and long life of your STEMCO Moisture Ejector, the compartment on the blue actuating end of the unit should be cleaned at least once in the fall of the year.

This is accomplished by simply removing the actuating air line fitting (blue end) and "blowing-out" with an air hose and nozzle, or removing the blue actuating end cap and wiping it out.



*A Higher Standard of Performance.<sup>SM</sup>*

ISO/TS 16949

STEMCO and Pro-Torq are registered trademarks of STEMCO LP  
©2009 STEMCO LP

### STEMCO - USA

P.O. Box 1989 • Longview, TX 75606-1989  
(903) 758-9981 • 1-800-527-8492 • FAX: 1-800-874-4297  
[www.stemco.com](http://www.stemco.com)

### STEMCO - Canada

5900 Ambler Drive, Units 4 & 5 • Mississauga, ON L4W 2N3  
(905) 206-9922 • 877-232-9111 • FAX: 877-244-4555

Printed in the USA  
Part No. 09-930-2125  
Hudson 10-536 • 2/09